



HUMPHREY'S
BUILDING SUPPLY



Moulding Catalog





Table of Contents

Ceiling

CROWN	1-3
CORNICE	4
BED MOULD	4
COVE/SCOTIA	5

Door & Window

CASING	6-8
BRICK MOULD	9
DRIP CAP	9
STOOL	9
STOPS	11

Wall & Trim

CHAIR RAIL	12
PICTURE MOULD	12
OUTSIDE CORNER	12
BAND/PANEL	13
MULLION	14
GLASS BEAD	14

Floor

BASE	15-16
BASE CAP	17
BASE SHOE	17

General Purpose Moulding

SCREEN	18
LATTICE	18
SQUARE	19
ROUNDS	20
RAILS	21

Poplar Moulding

PRIMED POPLAR	22
---------------	----

Stair Treads

OAK/SYP	23
---------	----

PVC Moulding

ROYAL PVC	24-25
-----------	-------

****Profiles are not to scale****

PINE = Ponderosa Pine
RAD = Radiata Pine (limited profiles)
JPRMD = Jesso Primed Finger Joint Pine
PRMD = Buff Primed Finger Joint Pine
OAK = Red Oak
DFIR = Douglas Fir

CROWN

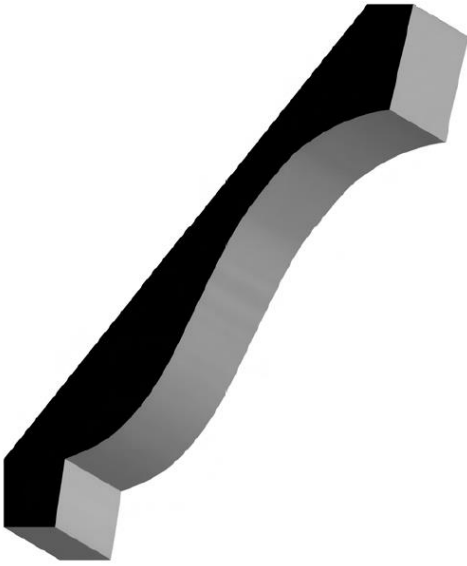

LWM 57
11/16 X 5-1/4
PINE - R/L
8004

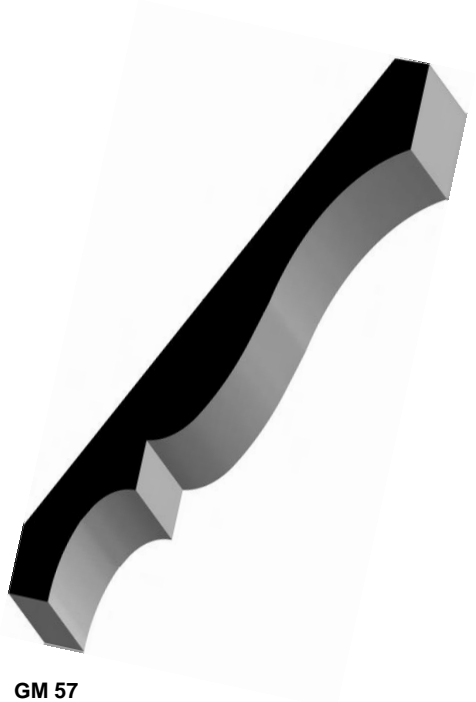

GM 57
9/16 X 5-1/4
JPRMD - 16/0
8027

All Jesso Primed Mouldings (JPRMD)
are for **INTERIOR USE ONLY**

CROWN

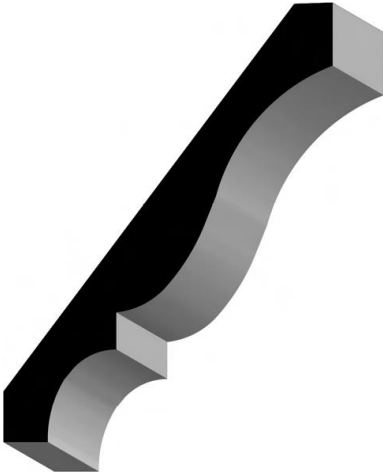

LWM 47
9/16 X 4-5/8
JPRMD – 16/0
8013
IN STOCK

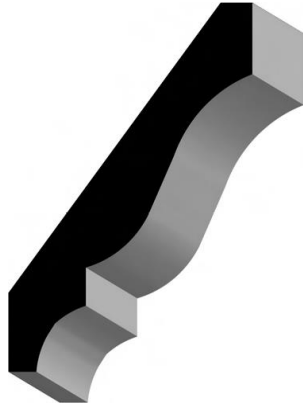

LWM 49
9/16 X 3-5/8
PINE - R/L
JPRMD – 16/0
8009
IN STOCK

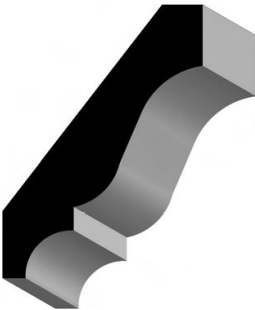

WM 52
9/16 X 2-3/4
PINE - R/L
JPRMD – 16/0
8010
IN STOCK



GM 47
1 1/16 X 2-1/2
PINE - R/L
8047

CROWN



LGM 48
 11/16 X 4-5/8
 PINE - R/L
8005
IN STOCK

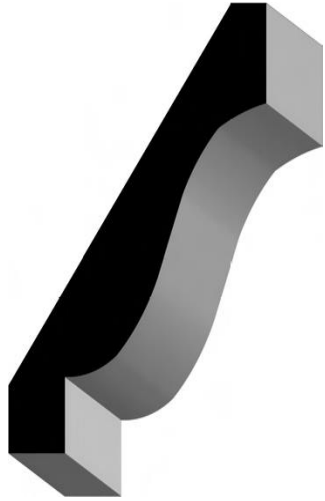

GM 48
 11/16 X 4-1/4
 PINE - R/L
8006

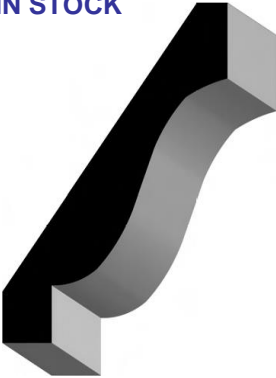

GM 49
 9/16 X 3-5/8
 PINE - R/L
8002



WM 57
 9/16 X 3-1/4
 PINE - R/L
8000

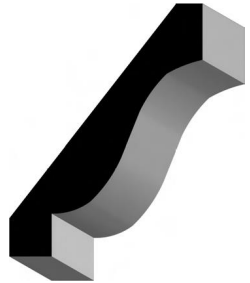

GM 52
 9/16 X 2-3/4
 PINE - R/L
8003

CORNICE

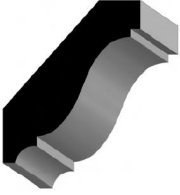

LWM 60
9/16 X 1-3/4
PINE - R/L
8622

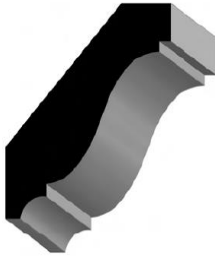

WM 67
9/16 X 2-1/4
PINE - R/L
8624

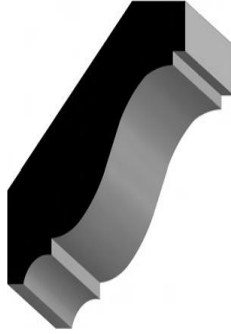

WM 68
9/16 X 3-1/4
PINE - R/L
8623

BED MOULD



WM 76
9/16 X 1-1/2
PINE - R/L
8017



WM 74
9/16 X 1-3/4
PINE - R/L
8016
IN STOCK

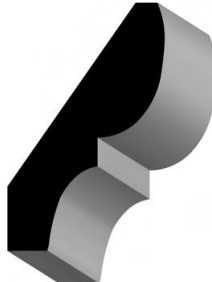

WM 72
9/16 X 2-1/4
PINE - R/L
8018
IN STOCK



WM 70
9/16 X 2-3/4
PINE - R/L
8019

COVE/SCOTIA



WM 86
9/16 X 1-5/8
PINE – R/L



WM 85
9/16 X 1-3/4
PINE – R/L

8024
IN STOCK



WM 84
9/16 X 2-1/4
PINE – R/L
8025



LWM 82
9/16 X 2-3/4
PINE – R/L
8026



WM 101
1/2 X 1/2
PINE – R/L
PRMD – 16/0
8059B



WM 100
11/16 X 11/16
PINE – R/L
8052

IN STOCK



WM 96
5/8 X 3/4
PINE – R/L
PRMD – 16/0
OAK – R/L

8062
IN STOCK



WM 93
3/4 X 3/4
PINE – R/L
OAK – R/L



WM 95
11/16 X 7/8
PINE – R/L
8060



WM 94
11/16 X 1-1/8
PINE – R/L
8061

CASING

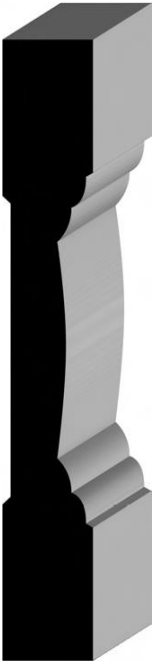

**GM 241
BELLY**
1-1/16 X 4-1/4
PINE - R/L
JPRMD - 16/0
B100

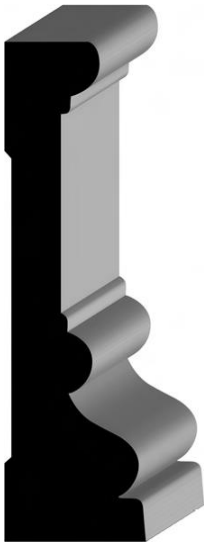

**LGM 7
WINDSOR**
1-1/16 X 3-1/2
JPRMD - 16/0, 7/2
B200
IN STOCK



**LGM 7
BABY WINDSOR**
11/16 X 2-1/2
JPRMD - 16/0
B300

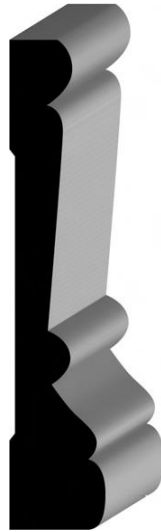

**GM 650
STAFFORD**
3/4 X 3-7/16
JPRMD - 15/0, 7/2
B225
IN STOCK



**GM 462
FLUTED**
9/16 X 3-1/4
PINE - 8/0
JPRMD - 16/0

All Jesso Primed Mouldings (JPRMD) are for **INTERIOR USE ONLY**

CASING



WM 444
 11/16 X 3-1/2
 PINE - R/L
 JPRMD – 15/0
8754
IN STOCK



WM 351
 11/16 X 2-1/2
 PINE - R/L & 7/1
 JPRMD – 14/0, 7/1
8710
IN STOCK



WM 356
 11/16 X 2-1/4
 PINE - R/L & 7/0
 JPRMD – 14/0
 RAD – R/L & 7/0

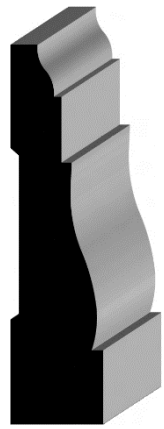

WM 366
 11/16 X 2-1/4
 PINE - R/L
 JPRMD – 14/0
1266

All Jesso Primed Mouldings (JPRMD)
 are for **INTERIOR USE ONLY**

CASING



WM 432
9/16 X 3-1/2
PINE - R/L
8308



WM 472
9/16 X 2-1/2
JPRMD - 16/0
8627
IN STOCK

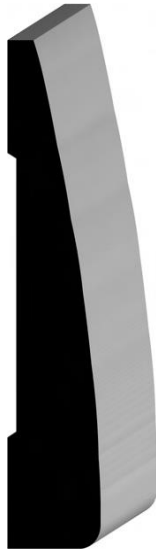

WM 448
11/16 X 3-1/2
PINE - R/L
8731
IN STOCK



WM 315
11/16 X 2-1/2
PINE - R/L & 7/1
JPRMD - 16/0, 7/1
8730
IN STOCK



WM 327
11/16 X 2-1/4
PINE - R/L
JPRMD - 14/0

All Jesso Primed Mouldings (JPRMD)
are for **INTERIOR USE ONLY**

BRICKMOULD

DRIP CAP



WM 180
 1-1/4 X 2
 PINE - R/L
 PRMD - 17/0
908
IN STOCK

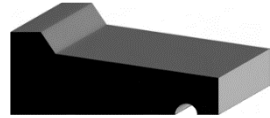

WM 196
 11/16 X 1-3/4
 PRMD - 16/0
923
IN STOCK

STOOL CAP



GM 207
 11/16 X 4-1/4
 PINE - R/L
8669B



GM 580
 11/16 X 2-1/2
 PINE - R/L
 PRMD - 16/0



LWM 1153
 11/16 X 3-1/2
 PINE - R/L
1268A



LWM 1155
 11/16 X 2-1/2
 PINE - R/L
1268B

ROSETTE

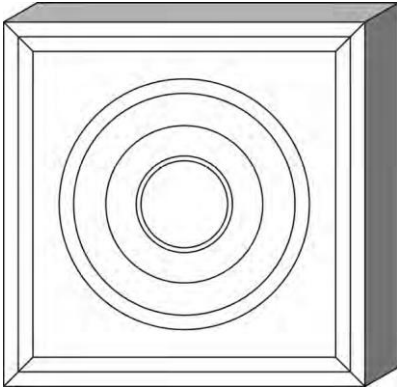

GM 33

1-1/16 X 3-3/4 X 3-3/4
PINE

GM 34

1-1/16 X 2-3/4 X 2-3/4
PINE

GM 35

1-1/16 X 4-3/8 X 4-3/8
PINE

GM 36

1-1/16 X 3-1/2 X 3-1/2
PINE

IN STOCK

Arauco TruChoice Jesso Primer

Jesso or clay coat is a type of primer, which covers the moulding with a smooth plaster like surface coating.

The mix or batch which is applied to the surface is a blend of paints, primers, plaster and oils which act much like the “mud mix” a contractor uses on a plaster wall.

The Jesso coating is applied by passing the moulding under a waterfall of the liquid mix primer and then sent through a die cast profile, which produces the consistent skim coating on the profile. The moulding is then left to dry and packaged for delivery.

The benefits of Jesso are the moulding is ready for painting with little preparation and only one coat of quality paint is needed to cover the moulding. It is the teeth that hold the paint to the surface. Jesso also reduces any telegraphing of flaws or imperfections from the wood substrate.

Jesso is for interior use only and should be stored in a dry clean area. Not recommend for high moisture areas.

WINDOW & DOOR STOP



LWM 913
7/16 X 4-1/4
PINE - R/L
8093B



WM 915
3/8 X 1-5/8
PINE - R/L
8095

IN STOCK



LWM 913
3/8 X 3-5/8
PINE - R/L
8093C



LWM 917
3/8 X 1-5/16
PINE - R/L
8096



LWM 913
3/8 X 2-1/2
PINE - R/L
8093A
IN STOCK



WM 857
3/8 X 1-1/4
PINE - R/L & 7/0
PRMD - 7/0
1287



WM 876
7/16 X 1-3/8
PINE - R/L

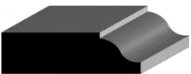

WM 947
3/8 X 1-1/4
PINE - R/L & 7/0
8098



WM 945
3/8 X 1-5/8
PINE - R/L
8090



WM 944
3/8 X 1-3/4
PINE - R/L
8104

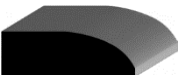

WM 887
3/8 X 1-1/4
PINE - 7/0



WM 888
3/8 X 1-1/8
PINE - 7/0

IN STOCK



WM 846
7/16 X 1-3/8
PINE - R/L

CHAIR RAIL



WM 390
 11/16 X 2-1/2
 JPRMD – 16/0
8630
IN STOCK

PICTURE MOULD



WM 273
 11/16 X 1-3/4
 PINE - R/L
8263



LWM 273
 11/16 X 1-3/8
 PINE - R/L
8288

CHAMFER

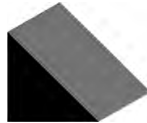

WM 995
 3/4 X 3/4
 PINE - R/L
B995

CORNERS



WM 204
 1-5/16 X 1-5/16
 PINE - R/L, 8/0
8238



WM 205
 1-1/8 X 1-1/8
 PINE - R/L
8200
IN STOCK



WM 206
 3/4 X 3/4
 PINE - R/L, 8/0
8240



WM 999
 5/16 X 1
 PINE - 8/0
8440
IN STOCK

PANEL/BAND

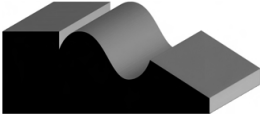

WM 217
11/16 X 1-3/4
PRMD - 16/0
8465
IN STOCK



WM 218
11/16 X 1-1/2
PINE - R/L
8463
IN STOCK



LWM 218
11/16 X 1-1/8
PINE - R/L
8462



LWM 185
11/16 X 1-3/4
PINE - R/L
8469
IN STOCK

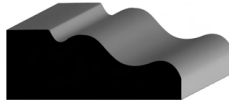

LWM 184
11/16 X 1-1/2
PINE - R/L
8470

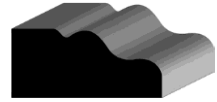

LWM 183
11/16 X 1-1/4
PINE - R/L
8471



WM 212
11/16 X 2-1/2
PINE - R/L
8180



GM 186
7/16 X 1-1/16
PINE - R/L
8451



GM 608
7/16 X 1-1/8
PINE - R/L
B608



GM 190
3/8 X 1
PINE - R/L
8161

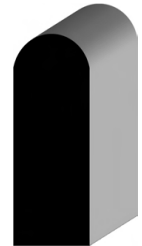

LWP 157
11/16 X 1-3/4
PINE - R/L
8144
IN STOCK

NOSING

MULLION/BATTEN



LWM 978
5/8 X 2-1/4
PINE - R/L
B636



WM 978
3/8 X 1-3/4
PINE - R/L
8138



LWM 972
5/16 X 2
PINE - R/L
1310



WM 133
11/16 X 1-3/4
PINE - R/L
8171

CAP MOULD



GM 373
11/16 X 1-3/8
PINE - R/L
B662



WM 294
11/16 X 1-1/8
PINE - R/L
B670

BACK BAND



WM 280
11/16 X 1-1/16
PINE - R/L
8313

GLASS BEAD



GM 148
3/8 X 1/2
PINE - R/L
8590

BASE

All Jesso Primed Mouldings (JPRMD) are for **INTERIOR USE ONLY**



LGM 57
9/16 X 7-1/4
MDF – 16/0
IN STOCK



LGM 57
9/16 X 5-1/2
MDF – 16/0



LGM 57
9/16 X 5-1/4
JPRMD – 16/0
B400
IN STOCK

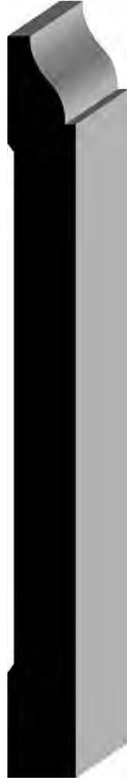

WM 618
9/16 X 5-1/4
PINE – R/L

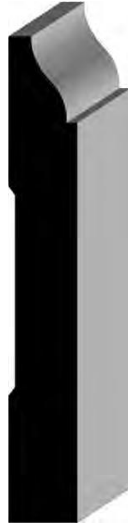

WM 622
9/16 X 3-1/2
PINE – R/L
JPRMD – 16/0
8712

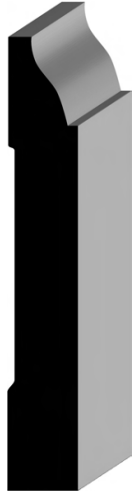

WM 623
9/16 X 3-1/4
PINE – R/L
JPRMD – 16/0
8712A

BASE

All Jesso Primed Mouldings (JPRMD) are for **INTERIOR USE ONLY**

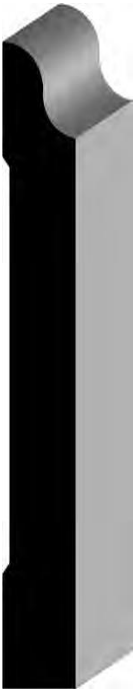

WM 660
9/16 X 4-1/4
PINE – R/L
8385B
IN STOCK

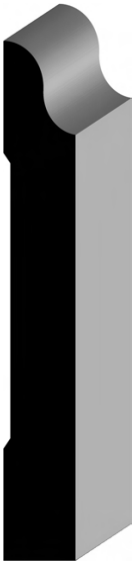

WM 662
9/16 X 3-1/2
PINE – R/L
JPRMD – 16/0
8385A
IN STOCK



WM 710
9/16 X 4-1/4
PINE – R/L
8721



WM 712
9/16 X 3-1/2
PINE – R/L
8720
IN STOCK



WM 713
9/16 X 3-1/4
PINE – R/L

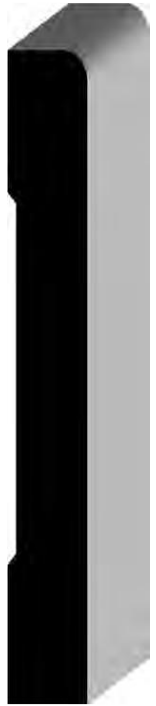

LWM 430
9/16 X 4-1/4
PINE – R/L
JPRMD – 16/0
B688

BASE CAP

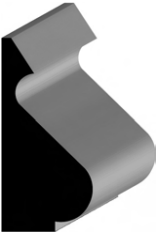

WM 163
11/16 X 1-3/8
PRMD – 16/0
8455
IN STOCK

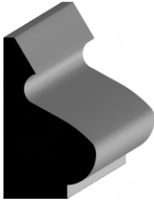

WM 164
11/16 X 1-1/8
PINE – R/L
PRMD – 16/0
8453
IN STOCK

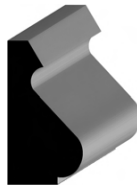

LWM 163
9/16 X 1
PINE – R/L
B658



WM 172
5/8 X 3/4
PINE – R/L
PRMD – 16/0
8042

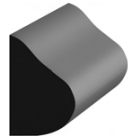

GM 346
1/2 X 3/4
PINE – R/L
B665

BASE SHOE

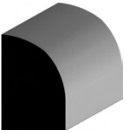

WM 126
1/2 X 3/4
PRMD – 16/0
8422
IN STOCK

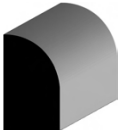

WM 127
7/16 X 3/4
PINE – R/L
8422
IN STOCK



WM 131
1/2 X 3/4
PINE – R/L
8423

SCREEN



GM 311
11/16 X 1-3/4
PINE – R/L
8767

SHELF CLEAT



WM 990
11/16 X 1-1/2
PINE – R/L
8242

SHELF EDGE



WM 142
1/4 X 3/4
PINE – R/L
8610
IN STOCK



WM 143
3/8 X 3/4
PINE – R/L
8140

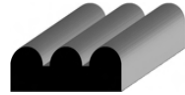

WM 144
1/4 X 3/4
PINE – R/L
8611
IN STOCK

LATTICE

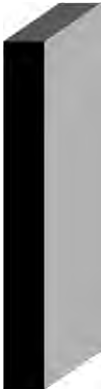

LWM 266
5/16 X 2-1/4
PINE – R/L
8628



LWM 265
1/4 X 1-3/4
PINE – R/L
8282
IN STOCK



LWM 267
1/4 X 1-3/8
PINE – R/L
8281
IN STOCK



LWM 268
1/4 X 1-1/8
PINE – R/L
8280

SQUARE

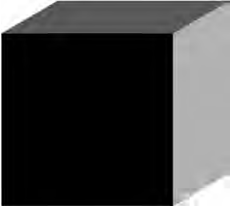

WM 236
1-5/8 X 1-5/8
PINE – R/L
8902

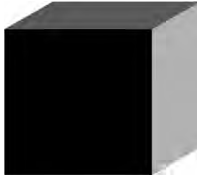

WM 237
1-5/16 X 1-5/16
PINE – R/L
8901

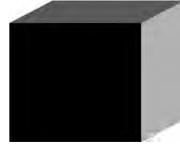

WM 238
1-1/16 X 1-1/16
PINE – R/L
8900

S4S STOCK



LWM 246
11/16 X 2-3/4
PINE – R/L
8615
IN STOCK



LWM 248
11/16 X 1-3/4
PINE – R/L
8614

PARTING STOP



WM 254
1/2 X 3/4
PINE – R/L, 6/0
8432

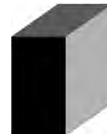

LWM 254
3/8 X 3/4
PINE – 6/0
8436
IN STOCK

QUARTER ROUND

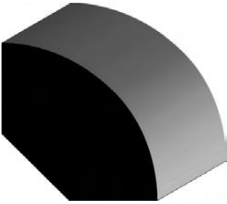

WM 104
11/16 X 1-3/8
PINE – R/L
8067

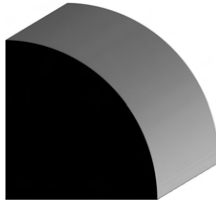

WM 103
1-1/16 X 1-1/16
PINE – R/L

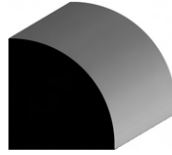

WM 105
3/4 X 3/4
PINE – R/L
PRMD – 16/0

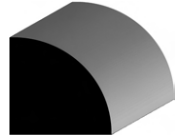

WM 106
11/16 X 11/16
PINE – R/L

8065
IN STOCK

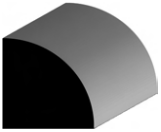

WM 107
5/8 X 5/8
PINE – R/L
8064

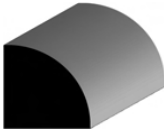

WM 108
1/2 X 1/2
PINE – R/L
8063

IN STOCK

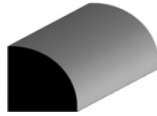

WM 109
3/8 X 3/8
PINE – R/L
8058

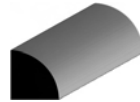

WM 110
1/4 X 1/4
PINE – R/L
8057

HALF ROUND



LWM 120
5/8 X 1-1/4
PINE – R/L
8079



WM 120
1/2 X 1
PINE – R/L
8078

IN STOCK



WM 122
3/8 X 11/16
PINE – R/L
8077



WM 123
5/16 X 5/8
PINE – R/L
8076



WM 124
1/4 X 1/2
PINE – R/L
8070

IN STOCK

FULL ROUND

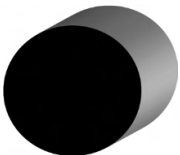

LWM 233
1-1/4 X 1-1/4
DFIR – R/L
8912

IN STOCK

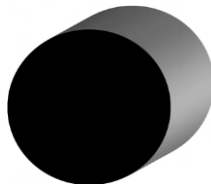

WM 232
1-5/8 X 1-5/8
DFIR – R/L
8913

HAND RAIL

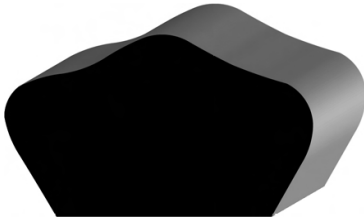

GM 359
 1-1/2 X 2-1/2
 DFIR – R/L
 23

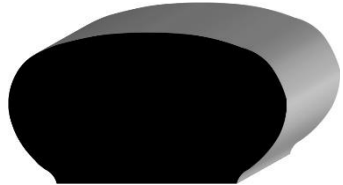

WM 240
 1-1/4 X 2-1/4
 DFIR – R/L

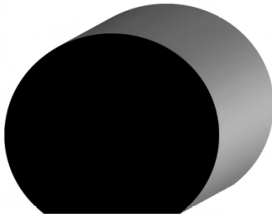

WM 231
 1-1/2 X 1-11/16
 DFIR – R/L
 75

IN STOCK

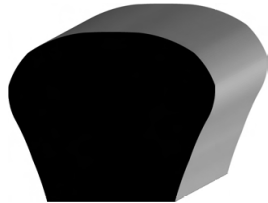

WM 230
 1-1/2 X 1-11/16
 DFIR – R/L
 66

PORCH RAIL

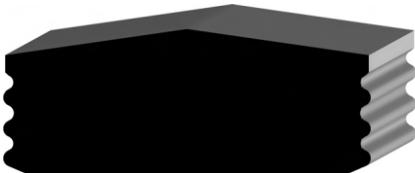

GM 44
 1-7/16 X 3-1/2
 DFIR – R/L



GM 62
 1-7/16 X 3-1/2
 DFIR – R/L

Finger Joint Primed Poplar



▲ **FJP611DY**
11/16" X 5-1/4"
Base



▲ **FJP550**
3/4" X 5-1/2"
Base



▲ **FJP499**
11/16" X 3-1/4"
Casing



▲ **FJP320**
11/16" X 3-1/2"
Casing



▲ **FJP312HK**
3/4" X 3-1/2"
Casing



▲ **FJP350**
3/4" X 3-1/2"
Casing

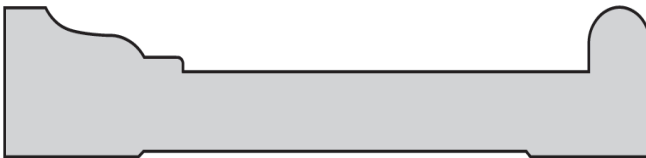

▲ **FJP512HK**
1-1/16" X 5-1/2"
Casing

Also available in FJP Pine

Stair Treads

Red Oak

$\frac{3}{4}$ " x 10 $\frac{1}{2}$ " x 36
 $\frac{3}{4}$ " x 10 $\frac{1}{2}$ " x 42
 $\frac{3}{4}$ " x 10 $\frac{1}{2}$ " x 48

$\frac{3}{4}$ " x 11 $\frac{1}{2}$ " x 36
 $\frac{3}{4}$ " x 11 $\frac{1}{2}$ " x 42
 $\frac{3}{4}$ " x 11 $\frac{1}{2}$ " x 48

$\frac{5}{4}$ " x 10 $\frac{1}{2}$ " x 42
 $\frac{5}{4}$ " x 10 $\frac{1}{2}$ " x 48

$\frac{5}{4}$ " x 11 $\frac{1}{2}$ " x 36
 $\frac{5}{4}$ " x 11 $\frac{1}{2}$ " x 42
 $\frac{5}{4}$ " x 11 $\frac{1}{2}$ " x 48



Southern Yellow Pine

$\frac{3}{4}$ " x 10 $\frac{1}{2}$ " x 36
 $\frac{3}{4}$ " x 10 $\frac{1}{2}$ " x 42
 $\frac{3}{4}$ " x 10 $\frac{1}{2}$ " x 48

$\frac{3}{4}$ " x 11 $\frac{1}{2}$ " x 36
 $\frac{3}{4}$ " x 11 $\frac{1}{2}$ " x 42
 $\frac{3}{4}$ " x 11 $\frac{1}{2}$ " x 48

$\frac{5}{4}$ " x 10 $\frac{1}{2}$ " x 42
 $\frac{5}{4}$ " x 10 $\frac{1}{2}$ " x 48

$\frac{5}{4}$ " x 11 $\frac{1}{2}$ " x 36
 $\frac{5}{4}$ " x 11 $\frac{1}{2}$ " x 42
 $\frac{5}{4}$ " x 11 $\frac{1}{2}$ " x 48





7960 Crown
2-3/4" x 3-1/2" x 12'



7158 Rams Crown
1-13/32" x 2" x 16'

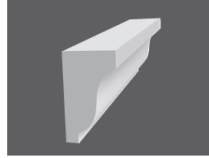

7714 Pediment
2" x 2-7/8" x 16'

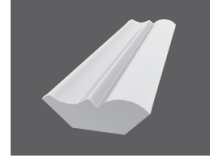

2598 Bed
9/16" x 1-9/16" x 16'

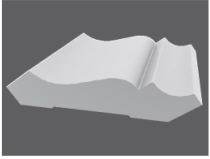

2853 Crown
9/16" x 2-3/4" x 16'

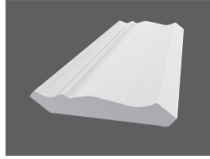

2435 Crown
9/16" x 3-5/8" x 16'

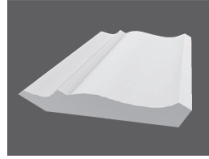

2592 Crown
11/16" x 4-5/8" x 16'

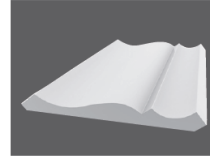

7491 Crown
9/16" x 5-1/4" x 16'

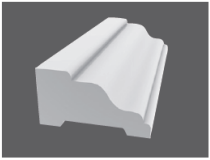

7202 Rake Moulding
1" x 2" x 16'

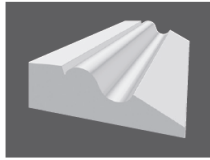

7901 Shingle/Panel Mould
23/32" x 1-23/32" x 16'

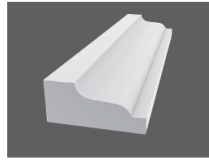

2599 Shingle Mould
11/16" x 1-5/8" x 16'

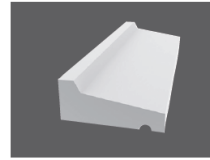

2449 Drip Cap
11/16" x 1-5/8" x 16'



2024 Quarter Round
1/2" x 1/2" x 16'



2689 Quarter Round
3/4" x 3/4" x 16'



2021 Cove/Scotia
3/4" x 3/4" x 16'

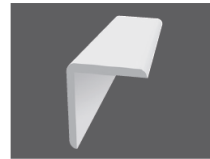

7719 Outside Corner
1-1/8" x 1-1/8" x 16'

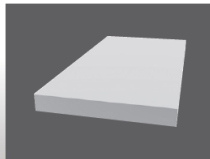

2018 Lattice
1/4" x 1-35/64"



2542 Baluster
1-1/2" x 1-1/2" x 16'

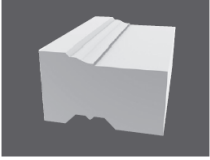

7137 Brick Mould
1-1/4" x 2" x 17'

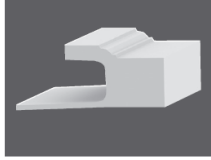

7351 J-Channel Brick Mould
1-1/4" x 2" x 18'

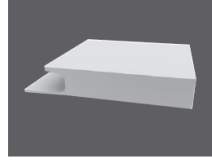

7651 J-Channel Casing
1-1/8" x 6-1/2"

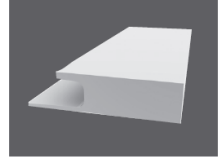

7467 J-Channel Casing
1-1/8" x 4-1/2" x 18'

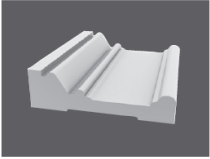

2369 RB3 Casing
1" x 3-1/2" x 16'

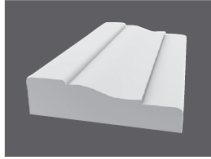

2440 Colonial Casing
11/16" x 2-1/2" x 16'

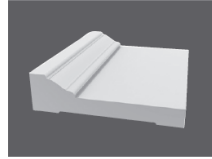

2590 Back Band
1-1/16" x 4-1/2" x 16'

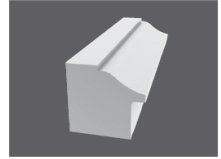

7152 Back Band
1-11/32" x 1-13/32" x 16'



7117 Sub Sill
1-1/4" x 5-1/4" x 7'



7118 Sill Nosing
1-5/16" x 1-3/8" x 16'



7717 Sill Nosing
1-13/16" x 2" x 16'



7435 Sill Nosing (Historic)
1-3/4" x 2-13/16" x 16'



7631 Sill Nosing
1-3/4" x 2" x 16'



7640 Sill Nosing
2-1/4" x 2-3/4" x 16'



2345 Sill Nosing
1-1/2" x 1-5/8" x 16'

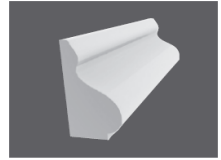

2450 Base Cap
11/16" x 1-1/8" x 16'

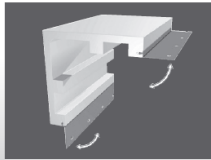

7653 Outside Corner
5-1/2" x 5-1/2"

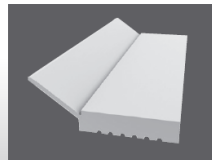

2149 Garage Door Stop
7/16" x 2" x 16'



Locations:

Building Supply

590 Main Road
Tiverton, RI 02878
Phone (401) 624-8800
Fax (401) 625-6655

Window & Door Design Gallery

8 Coddington Highway
Middletown, RI 02842
Phone (401) 841-8800

Paint Center

750 Aquidneck Avenue
Middletown, RI 02842
Phone (401) 841-9730

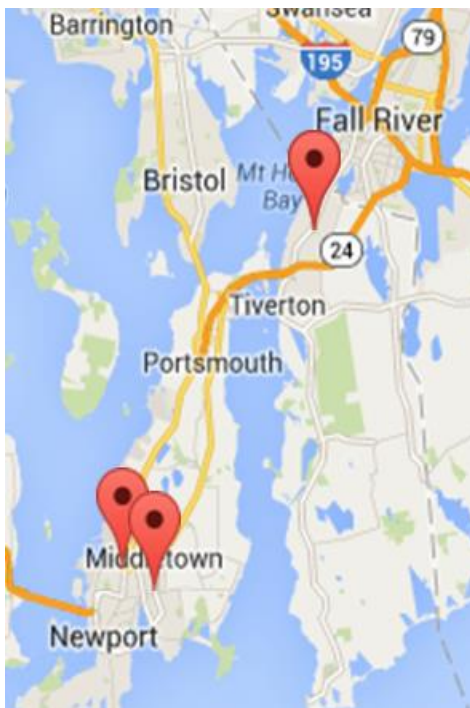

*For more information on Humphrey's Building Supply
please visit our website:*

www.buildwiththeh.com